

BLOOM TOWNSHIP SECTION 25 R12 TWP 11 MORGAN COUNTY, OH

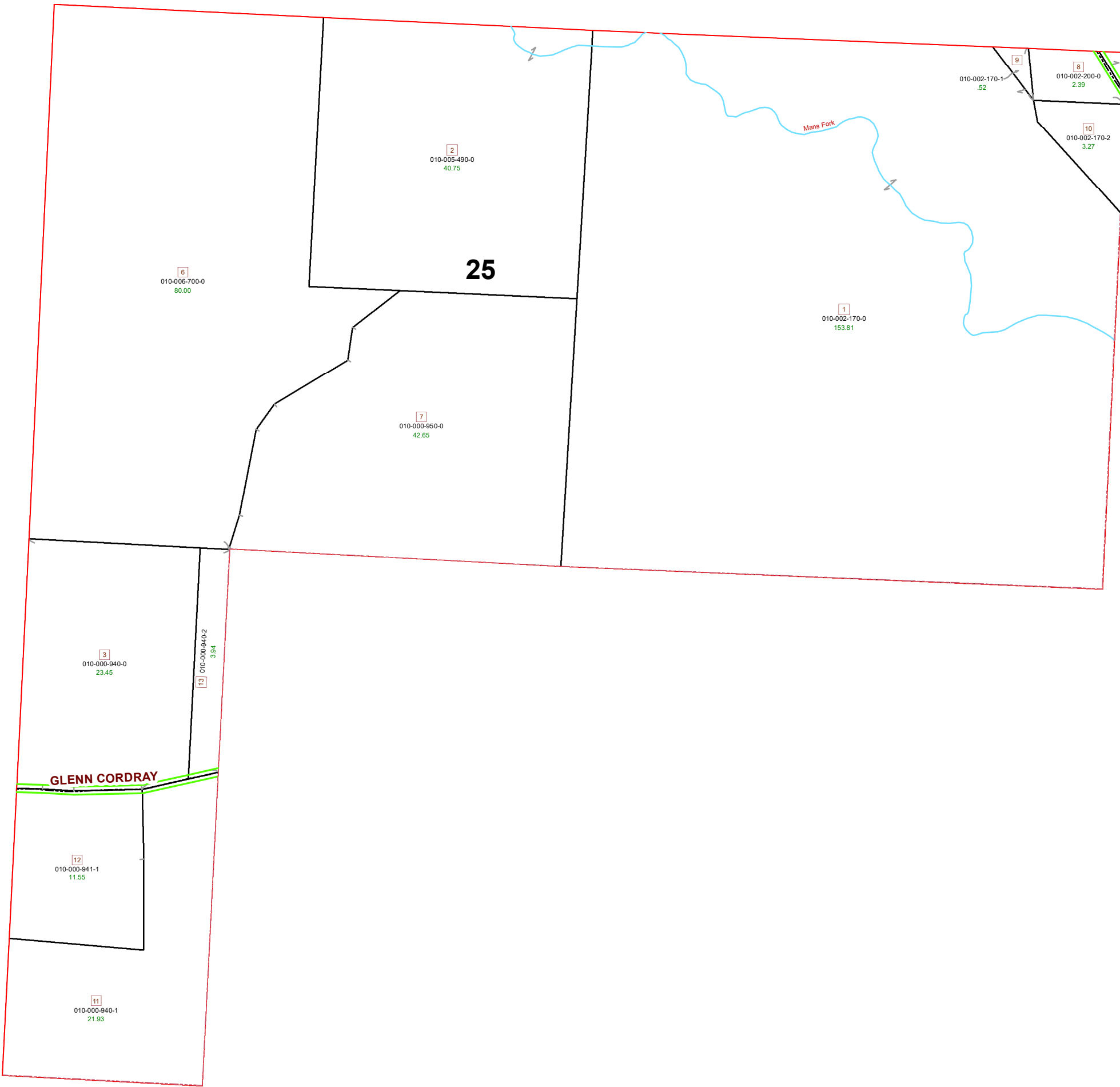

PIN	VOL	PAG	Owner	LegalDescr	Acres
010-002-170-0	OR226	1058	GREER ANGUS FARM LLC	R12 T11 S25 SD 1	153.81
010-002-170-1	OR34	64	GREER JOHN D & DENISE L	R12 T11 S25 SD 9	0.524
010-002-170-2	OR34	64	GREER JOHN D & DENISE L	R12 T11 S25 SD 10	3.274
010-002-200-0	OR226	1058	GREER JOHN D & DENISE L	R12 T11 S25 SD 8	2.39
010-000-940-2	OR220	2910	LOCKWOOD RALPH E TOD-RALPH	R12 T11 S25 SD 13	3.942
010-000-950-0	OR220	2910	LOCKWOOD RALPH E TOD-RALPH	R12 T11 S25 SD 7	42.652
010-005-490-0	OR233	1541	STEVENS MICHELLE L	R12 T11 S25 SD 2 S	40.75
010-000-940-1	OR205	563	WILSON JEFFREY W & CARLA F	R12 T11 S25 SD 11	21.933
010-000-941-1	OR160	226	WILSON JESSICA R	R12 T11 S25 SD 12	11.554
010-000-940-0	OR225	3488	WILSON JESSICA R	R12 T11 S25 SD 3	23.455
010-006-700-0	D.V. 16	401	WILSON JOHN W & JANET S	R12 T11 S25 SD 6	80

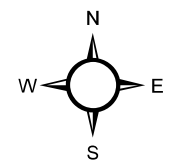

Boundaries	
	Lot
	ROW
	Section
	County
	Roads
	Township
	Sections
	Parcels
	Hidden
	Symbols

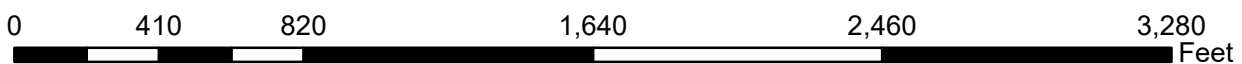

Disclaimer: The Information that these maps contains is for reference purposes only. Please bring any errors to the attention of the Engineer's Office staff. Thank You

Morgan County Engineer's Office
 Author: Marcia Wolfe
 Date: 7/20/2020